

Conceptual decision to improve the playground in Kyiv to an international competition «SBID students competition» (Universal product design)

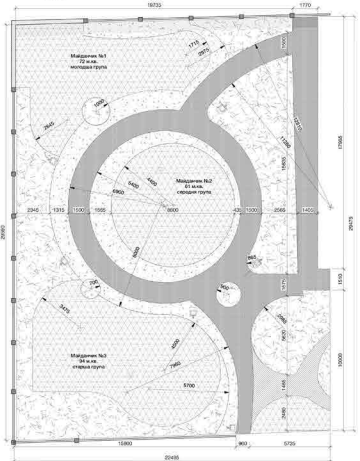

Plan Scale 1:100



A



A1

Concept

In the conditions of creation of a modern kindergarten, the design and equipment of the playground is of great importance. The playground design we offer creates the conditions for the maximum initiative of children and their greatest independence. Playground meets the physical and spiritual development of children and satisfies their requests, stimulates the growth of the child's abilities, helps them to acquire new useful life skills, promotes an active, amateur, creative game, during which children in the team can fully develop.

The playground design we offer creates the conditions for the maximum initiative of children and their greatest independence. Playground meets the physical and spiritual development of children and satisfies their requests, stimulates the growth of the child's abilities, helps them to acquire new useful life skills, promotes an active, amateur, creative game, during which children in the team can fully develop.

The whole area of the site has an area of 600 square meters, m and is divided into three zones: for children younger (2-3 years), middle (3-5 years) and older (5-6 years) group.

According to this age division, gaming equipment differs in accordance with the principles of inclusive learning.

The theme of the playground design is space, because the interior of the kindergarten is reminiscent of the nature of the Earth, so we decided that the space itself is a harmonious extension of it. As a result, the playground and sports equipment of the playground allows the child to feel in a spaceship surrounded by planets, stars, comets and friendly aliens.

The main universal module is half the sphere. This module, first of all, serves as a shelter that can not only protect children from the scorching sun, rain or snow, but also create a fabulous installation of the stary sky with the help of a special LED backlight. This module is also used in parts of gaming and sports equipment. Therefore, it is a unifying element for all three zones.

Slides, swings, carousels, game complexes are made of durable plastic, water-repellent plywood and iron structures that meet all safety standards.

Each area of the playground has special equipment for children with disabilities, because this category of people should feel full. For children with physical disabilities, slides are offered with special rides and descents, there are special swings, non-standard carousels.

An interactive whiteboard has been installed that allows not only healthy children but also those with visual and hearing impairments to explore the outside world. There is also a whiteboard for deaf children to learn sign language. This element of learning is useful for ordinary children as well, so they can easily communicate with the first.

As a flooring used special rubber, fresh grass and paving slabs.



Explication

- I. Junior group
  1. Swing for children with disabilities
  2. Sandbox on the legs
  3. The slide
  4. The arbor
  5. Development board with cubes
- II. The middle group
  6. Developmental game complex with ramps for children with wheelchairs
  7. A hill with a wall for climbing
  8. A carousel for children on wheelchairs
  9. The arbor
  10. Swing for 2 people
  11. A board for learning the alphabet and sign language
  12. Swing for balance
- III. Senior group
  13. A game complex in the form of a rocket
  14. Rope wall
  15. Carousel
  16. Interactive whiteboard
  17. Structure for rocking
  18. The arbor
  19. Bench
  20. Lantern



4,300  
4,000  
2,500  
2,400  
1,400  
0,000

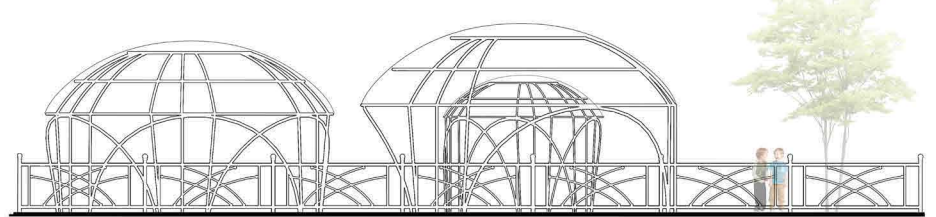

Cut B - B1 Scale 1:30

4,300  
4,000  
3,000  
2,500  
2,400  
1,400  
0,000

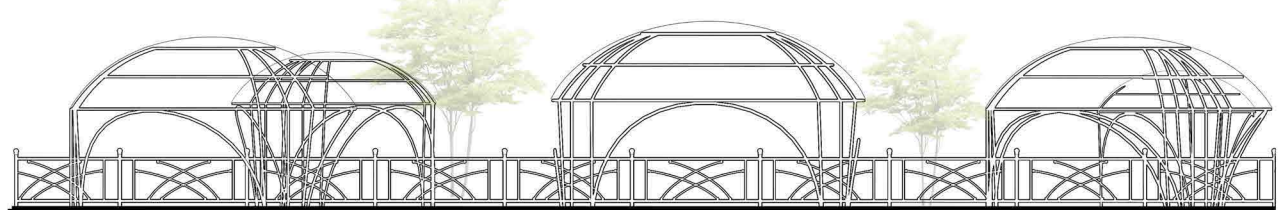

Cut A - A1 Scale 1:30



Anastasiia Borivska, 1st year student of master's program, specialty "Design of architectural and landscape environment"  
Kharkiv State Academy of Design and Fine Arts